

# Type PSU AC Motor Start Capacitors

## Non-polarized, Aluminum Electrolytic AC Motor Start Capacitors



The Type PSU is a compact non-polar, dual voltage rated, AC motor start capacitor constructed in a round rugged bakelite case. To extend the life of relay contact switches, the PSU can be purchased with optional bleeder resistors assembled with 1/4" quick-connect terminals. An optional mounting system consisting of a bracket that is attached to the capacitor case with one end cap is available. The PL end caps are for use with wiring through the bracket to the motor and the PLA end caps are for off motor mounting.

### Optional Enhancements

End Caps

Mounting Bracket



Motor Start Resistor



### Highlights

- ◆ Dual quick-connect terminals
- ◆ Rugged bakelite case
- ◆ Compact Size
- ◆ Resistor options
- ◆ Mounting options
- ◆ Non-polar
- ◆ Meets EIA RS-463 Type 2 (Normal Performance)
- ◆ Listed under UL file no. E128034

### Specifications



Complies with the EU Directive 2002/95/EC requirement restricting the use of Lead (Pb), Mercury (Hg), Cadmium (Cd), Hexavalent chromium (Cr(VI)), PolyBrominated Biphenyls (PBB) and PolyBrominated Diphenyl Ethers (PBDE).

<b>Capacitance Range:</b>	21 $\mu$ F to 1280 $\mu$ F
<b>Voltage Range</b>	110 Vac to 330 Vac
<b>Capacitance Tolerance:</b>	See ratings table
<b>Operating Temperature Range:</b>	-40 °C to 65 °C
<b>Storage Temperature Range:</b>	-55 °C to 85 °C
<b>Operating Frequency:</b>	50 Hz to 60 Hz
<b>Power Factor:</b>	10% max (12% $\leq$ 30 $\mu$ F)

### Ratings

Cap ( $\mu$ F)	Catalog Part Number	Voltage (Vac)	Case Code	Diameter $\pm$ .015 (Inches)	Length $\pm$ .06 (Inches)
21-25	PSU2115	110/125	1	1 7/16	2 3/4
25-30	PSU2515	110/125	1	1 7/16	2 3/4
30-36	PSU3015	110/125	1	1 7/16	2 3/4
36-43	PSU3615	110/125	1	1 7/16	2 3/4
43-52	PSU4315	110/125	1	1 7/16	2 3/4
47-56	PSU4715	110/125	1	1 7/16	2 3/4
53-64	PSU5315	110/125	1	1 7/16	2 3/4
64-77	PSU6415	110/125	1	1 7/16	2 3/4
72-86	PSU7215	110/125	1	1 7/16	2 3/4
88-106	PSU8815	110/125	1	1 7/16	2 3/4
108-130	PSU10815	110/125	1	1 7/16	2 3/4
124-149	PSU12415	110/125	1	1 7/16	2 3/4
130-156	PSU13015	110/125	1	1 7/16	2 3/4
145-174	PSU14515	110/125	1	1 7/16	2 3/4
161-193	PSU16115	110/125	1	1 7/16	2 3/4
189-227	PSU18915A	110/125	1	1 7/16	2 3/4
200-240	PSU20015	110/125	2	1 7/16	3 3/8

Cap ( $\mu$ F)	Catalog Part Number	Voltage (Vac)	Case Code	Diameter $\pm$ .015 (Inches)	Length $\pm$ .06 (Inches)
216-259	PSU21615	110/125	2	1 7/16	3 3/8
216-259	PSU21615A	110/125	1	1 7/16	2 3/4
233-280	PSU23315A	110/125	2	1 7/16	3 3/8
233-280	PSU23315B	110/125	1	1 7/16	2 3/4
243-292	PSU24315A	110/125	2	1 7/16	3 3/8
243-292	PSU24315B	110/125	1	1 7/16	2 3/4
270-324	PSU27015A	110/125	2	1 7/16	3 3/8
270-324	PSU27015B	110/125	1	1 7/16	2 3/4
300-360	PSU30015	110/125	4	1 13/16	3 3/8
324-389	PSU32415A	110/125	3	1 7/16	4 3/8
324-389	PSU32415B	110/125	1	1 7/16	2 3/4
340-408	PSU34015	110/125	4	1 13/16	3 3/8
340-408	PSU34015A	110/125	2	1 7/16	3 3/8
378-454	PSU37815	110/125	4	1 13/16	3 3/8
378-454	PSU37815A	110/125	2	1 7/16	3 3/8
400-480	PSU40015	110/125	4	1 13/16	3 3/8
400-480	PSU40015A	110/125	2	1 7/16	3 3/8

See page 5.00 for capacitor hardware and resistor options.

# Type PSU AC Motor Start Capacitors

## Ratings

Cap ( $\mu$ F)	Catalog Part Number	Voltage (Vac)	Case Code	Diameter $\pm 0.15$ (Inches)	Length $\pm 0.06$ (Inches)
430-516	PSU43015A	110/125	4	1 13/16	3 3/8
430-516	PSU43015B	110/125	2	1 7/16	3 3/8
460-552	PSU46015A	110/125	4	1 13/16	3 3/8
460-552	PSU46015B	110/125	2	1 7/16	3 3/8
540-648	PSU54015A	110/125	4	1 13/16	3 3/8
540-648	PSU54015B	110/125	5	1 13/16	4 3/8
590-708	PSU59015A	110/125	5	1 13/16	4 3/8
590-708	PSU59015B	110/125	4	1 13/16	3 3/8
645-774	PSU64515	110/125	5	1 13/16	4 3/8
645-774	PSU64515A	110/125	4	1 13/16	3 3/8
708-850	PSU70815	110/125	5	1 13/16	4 3/8
708-850	PSU70815A	110/125	4	1 13/16	3 3/8
720-864	PSU72015	110/125	5	1 13/16	4 3/8
720-864	PSU72015A	110/125	4	1 13/16	3 3/8
800-960	PSU80015	110/125	5	1 13/16	4 3/8
800-960	PSU80015A	110/125	4	1 13/16	3 3/8
815-978	PSU81515	110/125	5	1 13/16	4 3/8
815-978	PSU81515A	110/125	4	1 13/16	3 3/8
829-995	PSU82915A	110/125	5	1 13/16	4 3/8
829-995	PSU82915B	110/125	4	1 13/16	3 3/8
850-1020	PSU85015	110/125	5	1 13/16	4 3/8
850-1020	PSU85015A	110/125	4	1 13/16	3 3/8
1000-1200	PSU100015A	110/125	7	2 1/16	4 3/8
1020-1224	PSU102015	110/125	7	2 1/16	4 3/8
1175-1410	PSU117515	110/125	7	2 1/16	4 3/8
1280-1536	PSU128015	110/125	7	2 1/16	4 3/8
21-25	PSU2165A	165	1	1 7/16	2 3/4
25-30	PSU2565A	165	1	1 7/16	2 3/4
30-36	PSU3065A	165	1	1 7/16	2 3/4
36-43	PSU3665A	165	1	1 7/16	2 3/4
43-52	PSU4365A	165	1	1 7/16	2 3/4
47-56	PSU4765A	165	1	1 7/16	2 3/4
53-64	PSU5365A	165	1	1 7/16	2 3/4
64-77	PSU6465A	165	1	1 7/16	2 3/4
72-86	PSU7265A	165	1	1 7/16	2 3/4
88-106	PSU8865	165	2	1 7/16	3 3/8
88-106	PSU8865A	165	1	1 7/16	2 3/4
108-130	PSU10865	165	2	1 7/16	3 3/8
108-130	PSU10865A	165	1	1 7/16	2 3/4
124-149	PSU12465	165	2	1 7/16	3 3/8
124-149	PSU12465A	165	1	1 7/16	2 3/4
130-156	PSU13065	165	2	1 7/16	3 3/8
130-156	PSU13065A	165	1	1 7/16	2 3/4
145-174	PSU14565	165	2	1 7/16	3 3/8
145-174	PSU14565A	165	1	1 7/16	2 3/4
161-193	PSU16165	165	2	1 7/16	3 3/8
161-193	PSU16165A	165	1	1 7/16	2 3/4

Cap ( $\mu$ F)	Catalog Part Number	Voltage (Vac)	Case Code	Diameter $\pm 0.15$ (Inches)	Length $\pm 0.06$ (Inches)
189-227	PSU18965B	165	2	1 7/16	3 3/8
189-227	PSU18965C	165	1	1 7/16	2 3/4
216-259	PSU21665A	165	4	1 13/16	3 3/8
233-280	PSU23365	165	3	1 7/16	4 3/8
233-280	PSU23365A	165	4	1 13/16	3 3/8
243-292	PSU24365	165	3	1 7/16	4 3/8
243-292	PSU24365A	165	4	1 13/16	3 3/8
270-324	PSU27065A	165	3	1 7/16	4 3/8
270-324	PSU27065B	165	4	1 13/16	3 3/8
324-389	PSU32465	165	5	1 13/16	4 3/8
324-389	PSU32465A	165	4	1 13/16	3 3/8
340-408	PSU34065	165	5	1 13/16	4 3/8
340-408	PSU34065A	165	4	1 13/16	3 3/8
378-454	PSU37865	165	5	1 13/16	4 3/8
378-454	PSU37865A	165	4	1 13/16	3 3/8
400-480	PSU40065	165	5	1 13/16	4 3/8
400-480	PSU40065A	165	4	1 13/16	3 3/8
430-516	PSU43065	165	5	1 13/16	4 3/8
430-516	PSU43065A	165	4	1 13/16	3 3/8
460-552	PSU46065	165	5	1 13/16	4 3/8
460-552	PSU46065A	165	4	1 13/16	3 3/8
540-648	PSU54065	165	7	2 1/16	4 3/8
540-648	PSU54065A	165	4	1 13/16	3 3/8
21-25	PSU2135	220/250	1	1 7/16	2 3/4
25-30	PSU2535	220/250	1	1 7/16	2 3/4
30-36	PSU3035	220/250	1	1 7/16	2 3/4
36-43	PSU3635	220/250	1	1 7/16	2 3/4
43-52	PSU4335B	220/250	2	1 7/16	3 3/8
43-52	PSU4335C	220/250	1	1 7/16	2 3/4
47-56	PSU4735	220/250	2	1 7/16	3 3/8
47-56	PSU4735A	220/250	1	1 7/16	2 3/4
53-64	PSU5335	220/250	2	1 7/16	3 3/8
53-64	PSU5335A	220/250	1	1 7/16	2 3/4
64-77	PSU6435	220/250	2	1 7/16	3 3/8
64-77	PSU6435A	220/250	1	1 7/16	2 3/4
72-86	PSU7235	220/250	4	1 13/16	3 3/8
88-106	PSU8835	220/250	4	1 13/16	3 3/8
108-130	PSU10835A	220/250	4	1 13/16	3 3/8
124-149	PSU12435	220/250	5	1 13/16	4 3/8
124-149	PSU12435A	220/250	4	1 13/16	3 3/8
130-156	PSU13035	220/250	5	1 13/16	4 3/8
130-156	PSU13035A	220/250	4	1 13/16	3 3/8
145-174	PSU14535	220/250	5	1 13/16	4 3/8
145-174	PSU14535A	220/250	4	1 13/16	3 3/8
161-193	PSU16135A	220/250	7	2 1/16	4 3/8
189-227	PSU18935A	220/250	7	2 1/16	4 3/8
189-227	PSU18935B	220/250	6	2 1/16	3 3/8

See page 5.000 for capacitor hardware and resistor options.

# Type PSU AC Motor Start Capacitors

## Ratings

Cap ( $\mu$ F)	Catalog Part Number	Voltage (Vac)	Case Code	Diameter $\pm.015$ (Inches)	Length $\pm.06$ (Inches)
216-259	PSU21635A	220/250	7	2 1/16	4 3/8
216-259	PSU21635B	220/250	6	2 1/16	3 3/8
233-280	PSU23335A	220/250	7	2 1/16	4 3/8
233-280	PSU23335B	220/250	6	2 1/16	3 3/8
243-292	PSU24335	220/250	7	2 1/16	4 3/8
243-292	PSU24335A	220/250	6	2 1/16	3 3/8
270-324	PSU27035A	220/250	7	2 1/16	4 3/8
270-324	PSU27035B	220/250	6	2 1/16	3 3/8
16-20	PSU1630	330	2	1 7/16	3 3/8
18-22	PSU1830	330	4	1 13/16	3 3/8
21-25	PSU2130	330	1	1 7/16	2 3/4
21-25	PSU2130A	330	2	1 7/16	3 3/8
25-30	PSU2530	330	2	1 7/16	3 3/8
30-36	PSU3030	330	2	1 7/16	3 3/8
36-43	PSU3630	330	2	1 7/16	3 3/8
43-52	PSU4330	330	2	1 7/16	3 3/8
43-52	PSU4330A	330	4	1 13/16	3 3/8
47-56	PSU4730	330	4	1 13/16	3 3/8
53-64	PSU5330B	330	4	1 13/16	3 3/8
64-77	PSU6430	330	4	1 13/16	3 3/8

Cap ( $\mu$ F)	Catalog Part Number	Voltage (Vac)	Case Code	Diameter $\pm.015$ (Inches)	Length $\pm.06$ (Inches)
72-86	PSU7230B	330	5	1 13/16	4 3/8
72-86	PSU7230C	330	4	1 13/16	3 3/8
88-106	PSU8830A	330	5	1 13/16	4 3/8
88-106	PSU8830B	330	4	1 13/16	3 3/8
108-130	PSU10830B	330	7	2 1/16	4 3/8
124-149	PSU12430	330	8	2 9/16	4 3/8
124-149	PSU12430A	330	7	2 1/16	4 3/8
130-156	PSU13030	330	7	2 1/16	4 3/8
145-174	PSU14530A	330	7	2 1/16	4 3/8
161-193	PSU16130	330	8	2 9/16	4 3/8
161-193	PSU16130A	330	7	2 1/16	4 3/8
189-227	PSU18930	330	8	2 9/16	4 3/8
189-227	PSU18930A	330	7	2 1/16	4 3/8
216-259	PSU21630	330	8	2 9/16	4 3/8
216-259	PSU21630A	330	7	2 1/16	4 3/8
270-324	PSU27030	330	8	2 9/16	4 3/8
270-324	PSU27030A	330	7	2 1/16	4 3/8
378-454	PSU37830	330	8	2 9/16	4 3/8
460-552	PSU46030	330	8	2 9/16	4 3/8

See page 5.000 for capacitor hardware and resistor options.

Case Code	Inches		
	D ( $\pm.015$ )	L (+0.020, -0.030)	C (Ref.)
1	1-7/16 (1.4375)	2-3/4 (2.750)	1/2 (.500)
2	1-7/16 (1.4375)	3-3/8 (3.375)	1/2 (.500)
3	1-7/16 (1.4375)	4-3/8 (4.375)	1/2 (.500)
4	1-13/16 (1.8125)	3-3/8 (3.375)	5/8 (.625)
5	1-13/16 (1.8125)	4-3/8 (4.375)	5/8 (.625)
6	2-1/16 (2.0625)	3-3/8 (3.375)	7/8 (.875)
7	2-1/16 (2.0625)	4-3/8 (4.375)	7/8 (.875)
8	2-9/16 (2.5625)	4-3/8 (4.375)	7/8 (.875)

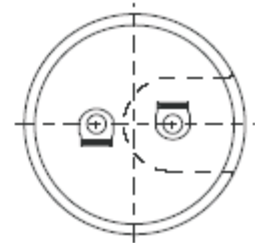

Single Disconnect Terminals  
(SQC)  
(All Cases)

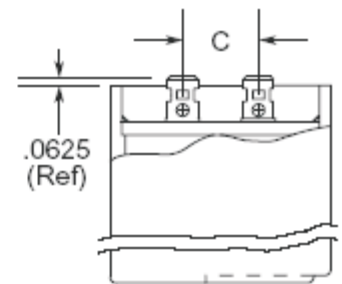

## Type PSU AC Motor Start Capacitors

---

**Notice and Disclaimer:** All product drawings, descriptions, specifications, statements, information and data (collectively, the "Information") in this datasheet or other publication are subject to change. The customer is responsible for checking, confirming and verifying the extent to which the Information contained in this datasheet or other publication is applicable to an order at the time the order is placed. All Information given herein is believed to be accurate and reliable, but it is presented without any guarantee, warranty, representation or responsibility of any kind, expressed or implied. Statements of suitability for certain applications are based on the knowledge that the Cornell Dubilier company providing such statements ("Cornell Dubilier") has of operating conditions that such Cornell Dubilier company regards as typical for such applications, but are not intended to constitute any guarantee, warranty or representation regarding any such matter – and Cornell Dubilier specifically and expressly disclaims any guarantee, warranty or representation concerning the suitability for a specific customer application, use, storage, transportation, or operating environment. The Information is intended for use only by customers who have the requisite experience and capability to determine the correct products for their application. Any technical advice inferred from this Information or otherwise provided by Cornell Dubilier with reference to the use of any Cornell Dubilier products is given gratis (unless otherwise specified by Cornell Dubilier), and Cornell Dubilier assumes no obligation or liability for the advice given or results obtained. Although Cornell Dubilier strives to apply the most stringent quality and safety standards regarding the design and manufacturing of its products, in light of the current state of the art, isolated component failures may still occur. Accordingly, customer applications which require a high degree of reliability or safety should employ suitable designs or other safeguards (such as installation of protective circuitry or redundancies or other appropriate protective measures) in order to ensure that the failure of an electrical component does not result in a risk of personal injury or property damage. Although all product-related warnings, cautions and notes must be observed, the customer should not assume that all safety measures are indicated in such warnings, cautions and notes, or that other safety measures may not be required.