

BS88, IEC269 Industrial HRC Fuse Links

NITD

Offset Bolted Tags 550V ac

Time-Current Characteristic Curve

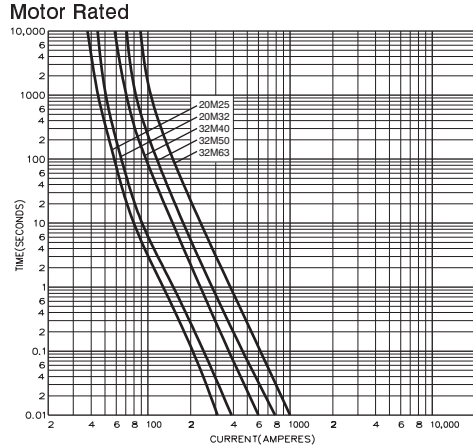
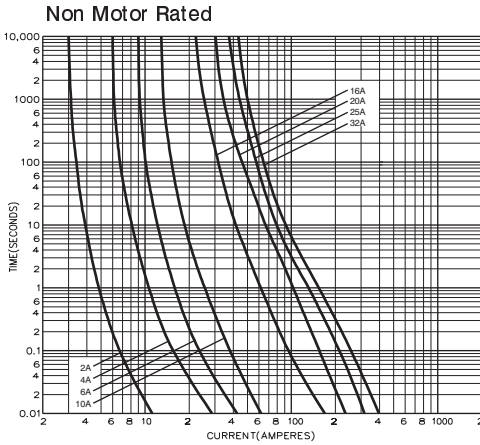

The Motor Rated NITD Fuse Links are suitable for use in our CAMASTER Fuse Holders

Dimensional Data

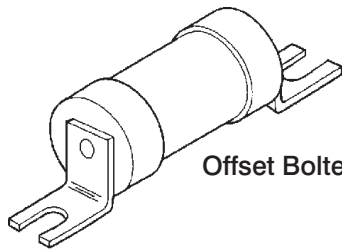

Offset Bolted Tag

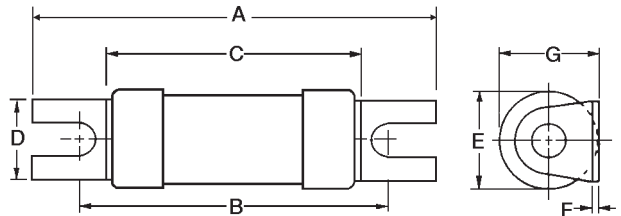

Catalog Number	I ² t (Ampere ² Seconds)			Nom. Watts Loss	Rated Voltage	Dimensions (inches/mm)						
	Amp Ratings	Pre-Arcing	Total at 415V			A	B	C	D	E	F	G
NITD2	2	1.3	4.5	0.9	550 ac	2.15 55.0	1.75 44.5	1.36 34.6	0.44 11.2	0.54 13.8	0.03 0.80	0.55 14.0
NITD4	4	7.8	27	1.4								
NITD6	6	29	100	1.8								
NITD10	10	120	400	2.1								
NITD16	16	120	470	1.8								
NITD20	20	260	1000	1.8								
NITD25	25	560	2300	2.0								
NITD32	32	710	3000	2.9								
NITD20M25	20M25	575	2300	1.6	415 ac	2.15 55.0	1.75 44.5	1.40 35.6	0.44 11.1	0.68 17.5	0.03 1.20	0.73 18.5
NITD20M32	20M32	720	3000	1.1								
NITD32M40	32M40	1500	6000	1.9								
NITD32M50	32M50	2700	8600	1.4								
NITD32M63	32M63	5000	13,400	1.0								

Packaging - 20 per carton

This bulletin is intended to clearly present comprehensive product data and provide technical information that will help the end user with design applications. Bussmann reserves the right, without notice, to change design or construction of any products and to discontinue or limit distribution of any products. Bussmann also reserves the right to change or update, without notice, any technical information contained in this bulletin. Once a product has been selected, it should be tested by the user in all possible applications.



Bussmann Division
Cooper (U.K.) Ltd
 Burton-on-the-Wolds
 Leicestershire, LE12 5TH
 United Kingdom
 Tel: (44) (0)1509 88 27 37
 Fax: (44) (0)1509 88 27 86

Head Office
 St. Louis, MO, U.S.A. Tel: (314) 527-3877 Fax: (800) 544-2570 International Fax: (314) 527-1445

